

The Lanyon Room

Situated on the ground floor off the main Hotel Reception, the Lanyon Room incorporates high quality integrated audio-visual facilities. Air-conditioned and complete with hearing loop, this level-access room is an excellent facility for events requiring easy access and flexibility in event set-up. The Lanyon Room is fitted with a hearing loop and is fully accessible for those with mobility restrictions.

Room Dimensions	Theatre	Team Circle	Boardroom	Classroom	U-Shape	Cabaret	Dinner (Round Tables)	Dinner (Block Table)
34.1m x 8.3m	240	80	n/a	140	60	160	180	n/a

Room Details	
Ground Floor	Yes
Natural Light	Yes
Dimmable Lighting	Yes
Blackout	Yes
Air Conditioning	Yes
Wi-fi	Yes
Wired Internet	Yes
13 Amp Electrical Sockets	14 Doubles 3 Singles

Audio-Visual Systems	
Fitted or Portable A/V Systems	Fitted
Lectern	Yes
Data Projector	One
Fitted or Portable Projection Screen	Fitted
DVD / VHS Combi Player	Yes
Amplifier & Speakers	Yes
Microphones	Lectern, handheld & lapel
Laptop	On Request



Room Location: Ground Floor, off Hotel Reception

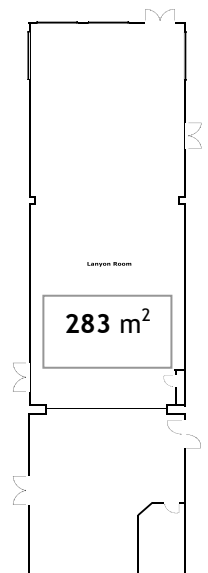

The Lanyon Room

The Lanyon Room is named in honour of the architect who designed Magherabuoy House - Sir Charles Lanyon. Lanyon was one of the leading architects of his time and designed many noted buildings, including Queen's University Belfast. The room can be divided into two sections and features a sprung dancefloor.

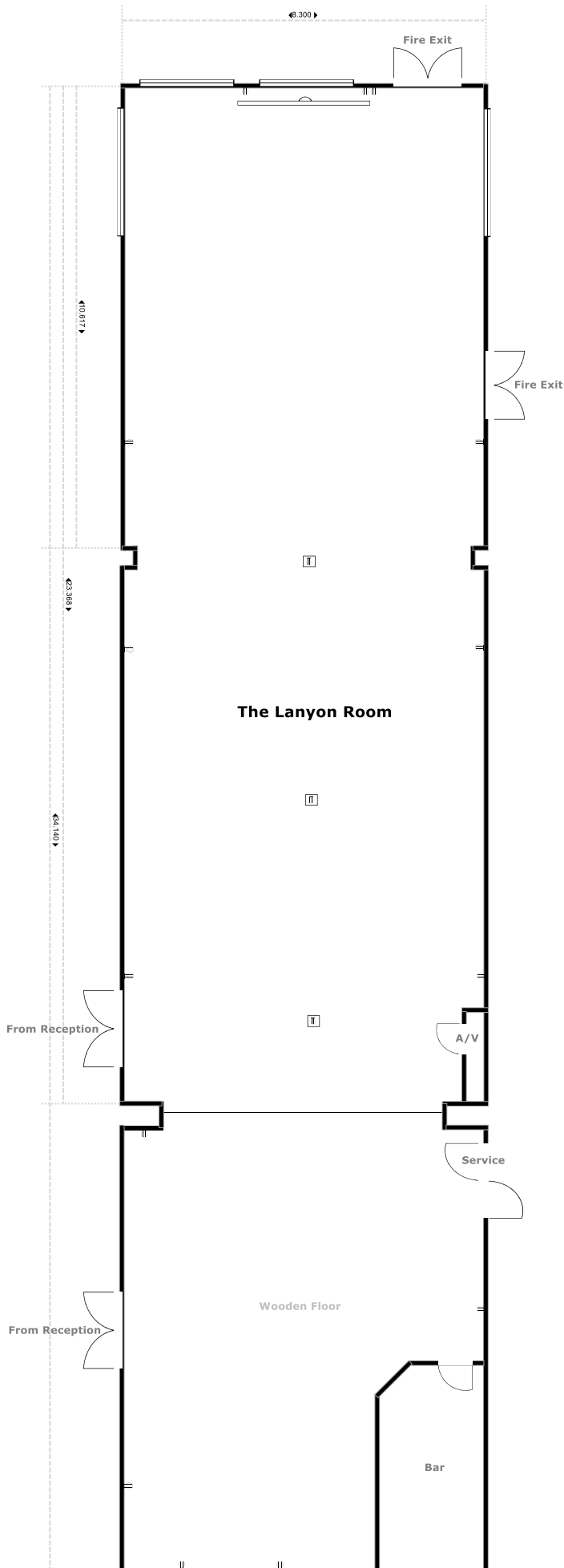

41 Magherabuoy Road, Portrush, Co. Antrim BT56 8NX
T +44 (0) 28 7082 3507
E enquiries@magherabuoy.co.uk
W www.magherabuoy.co.uk