

The Atlantic Room

Situated on the first floor of the original 19th Century Magherabuoy House, the Atlantic room enjoys lots of natural light with three feature windows, and has views extending across Portrush peninsula to the Western Isles of Scotland. The room offers an ideal setting for meetings and is an excellent space for exhibitions.

Room Dimensions	Theatre	Team Circle	Boardroom	Classroom	U-Shape	Cabaret	Dinner (Round Tables)	Dinner (Block Table)
11.2mx5.3m	60	30	24	28	28	30	40	30

Room Details	
Ground Floor	No
Natural Light	Yes
Dimmable Lighting	Yes
Blackout	Yes
Air Conditioning	No
Wi-fi	Yes
Wired Internet	Yes
13 Amp Electrical Sockets	4 Doubles 6 Singles

Audio-Visual Systems	
Fitted or Portable A/V Systems	Portable
Lectern	No
Data Projector	One
Fitted or Portable Projection Screen	Portable
DVD / VHS Combi Player	Yes
Amplifier & Speakers	Yes
Microphone	No
Laptop	On Request



Room Location: First Floor, Magherabuoy House

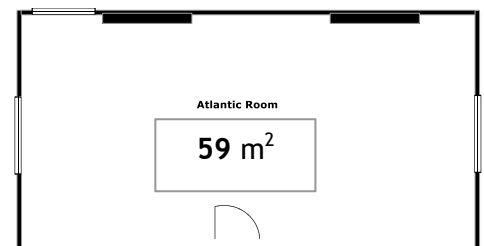

The Atlantic Room

This room is so-named because of the views it offers over the town of Portrush, and beyond across the North Atlantic. It can be set up in a variety of layouts, depending on your needs and is across the landing from Seaview and upstairs from the Sir Dawson Bates room.

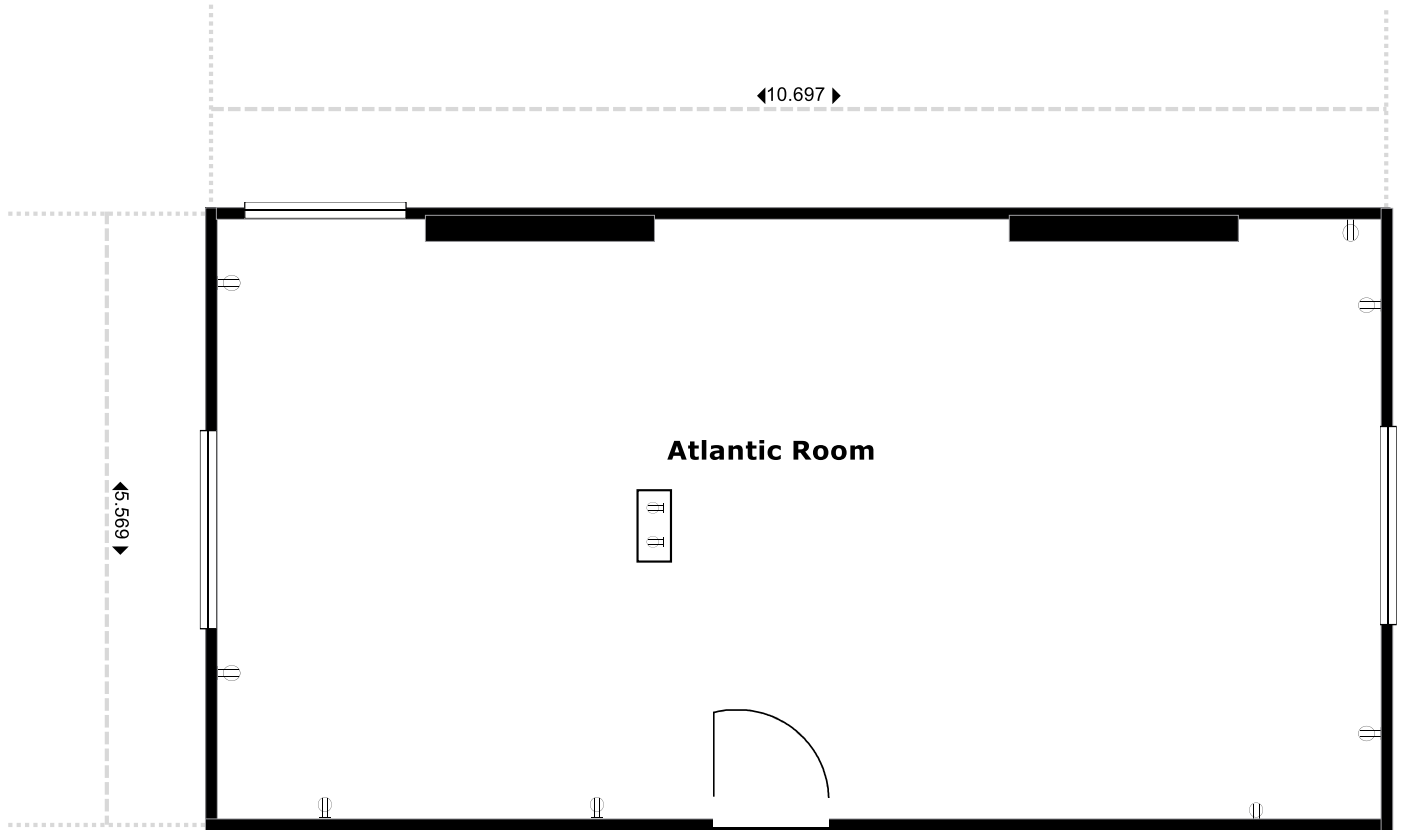

All measurements in Meters

